

Published : Jul 27, 2005

Rear End Sheet Metal

Rear end service panels

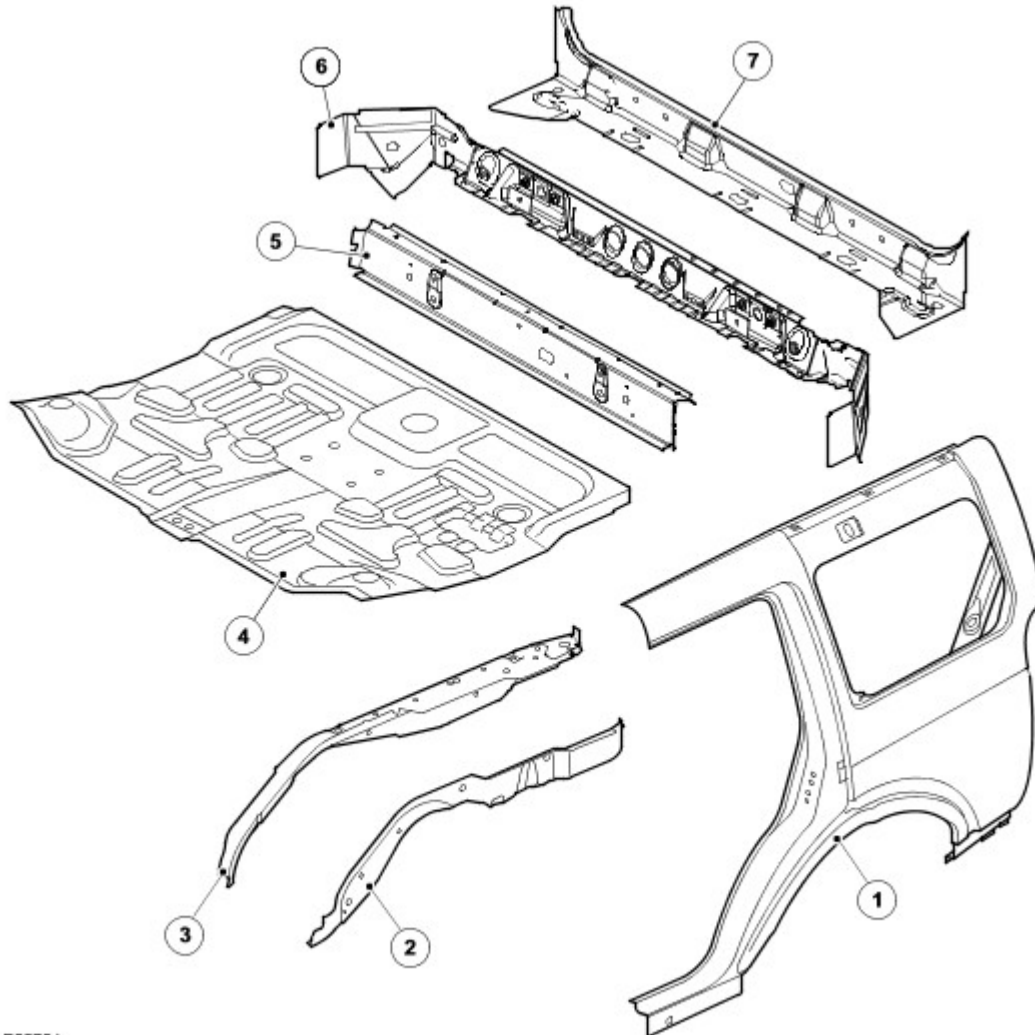

E55754

| Item | Description | Service part No |
|------|--------------------------|-----------------------------|
| 1 | Quarter panel outer | R/H ALA780100 L/H ALA780110 |
| 2 | Rear side member | R/H AGA780021 L/H AGA780031 |
| 3 | Rear side member | R/H AFD780080 L/H AFD780090 |
| 4 | Rear floor panel | AFD780010 |
| 5 | Rear crossmember | AQA780050 |
| 6 | Rear panel reinforcement | AQR780080 |
| 7 | Rear panel outer | AQA780030 |

Rear end service panels

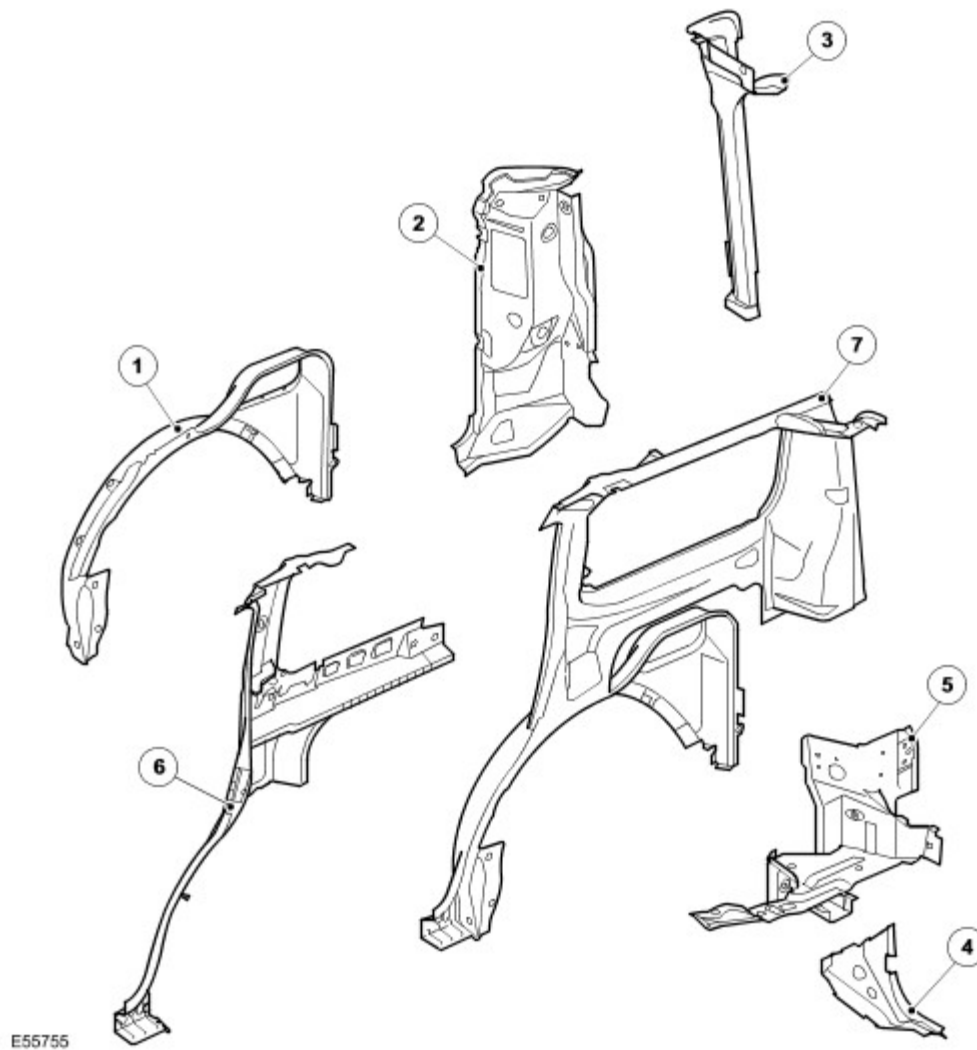

| Item | Description | Service part No |
|------|---|-----------------------------|
| 1 | Rear wheelhouse outer | R/H ALK780100 L/H ALK780110 |
| 2 | Rear lamp mounting panel | R/H AME780320 L/H AME780330 |
| 3 | Water drain panel | R/H AME780300 L/H AME780310 |
| 4 | D-pillar closing panel | R/H AFF780060 L/H AFF780070 |
| 5 | D-pillar inner lower panel assembly | R/H AGY780060 L/H AGY780070 |
| 6 | Inner quarter panel | R/H ALR780220 L/H ALR780230 |
| 7 | Inner quarter panel/side panel rear section | R/H ALJ780120 L/H ALJ780130 |

Time sechedules, front end

The following information shows the total time taken to replace single panels and complete assemblies. This time includes removal of Mechanical, Electrical and Trim (MET) items, plus paint times based on Metallic Clear Over Base Paint.

The times shown were generated by Thatcham (the motor insurance repair and research centre) and are to be used as a guide only.

Single panel times

| Panel Description | Petrol | Diesel |
|-------------------|--------|--------|
| Liftgate | 9.0 | 9.0 |
| Tailgate | 6.7 | 6.7 |
| Quarter panel L/H | 23.4 | 23.4 |
| Quarter panel R/H | 23.7 | 23.7 |

Combination panel replacement times

The following panel combination times show the total time to remove/refit body panels, MET items and any paint process.

Combination panel times

| Panel Description | Petrol | Diesel |
|------------------------------------|--------------------------|--------------------------|
| Rear bumper | | |
| D-Pillar closing panel L/H and R/H | | |
| Rear lamp panel | | |
| Rear crossmember | | |
| Rear panel | | |
| Quarter panel | | |
| Tailgate | | |
| Total Time | L/H 35.6 R/H 35.9 | L/H 35.6 R/H 35.9 |

Combination panel times

| Panel Description | Petrol | Diesel |
|------------------------------------|-------------|-------------|
| Rear bumper | | |
| D-Pillar closing panel L/H and R/H | | |
| Rear lamp panel L/H and R/H | | |
| Rear panel | | |
| Rear crossmember | | |
| Tailgate | | |
| Quarter panel L/H and R/H | | |
| Total Time | 62.1 | 62.1 |

Combination panel times

| Panel Description | Petrol | Diesel |
|-------------------------------------|--------|--------|
| Body off integraed frame | | |
| Rear floor panel section | | |
| Rear bumper | | |
| Rear side member section | | |
| D-Pillar closing panel | | |
| D-Pillar inner lower panel assembly | | |
| Rear lamp panel | | |
| | | |

| | | |
|-------------------|--------------------------|--------------------------|
| Rear panel | | |
| Rear crossmember | | |
| Tailgate | | |
| Quarter panel | | |
| Total Time | L/H 64.1 R/H 64.3 | L/H 64.3 R/H 64.5 |

Combination panel times

| Panel Description | Petrol | Diesel |
|---|-------------|-------------|
| Body off integraed frame | | |
| Rear floor panel section | | |
| Rear bumper | | |
| Rear side member section L/H and R/H | | |
| D-Pillar closing panel L/H and R/H | | |
| D-Pillar inner lower panel assembly L/H and R/H | | |
| Rear lamp panel L/H and R/H | | |
| Rear panel | | |
| Rear crossmember | | |
| Tailgate | | |
| Quarter panel L/H and R/H | | |
| Total Time | 87.4 | 87.6 |

Combination panel times

| Panel Description | Petrol | Diesel |
|-------------------------------------|-------------|-------------|
| Rear bumper | | |
| D-Pillar closing panel | | |
| D-Pillar inner lower panel assembly | | |
| Rear lamp panel | | |
| Rear panel | | |
| Rear crossmember | | |
| Tailgate | | |
| Quarter panel | | |
| Total Time | 48.7 | 48.7 |

Combination panel times

| Panel Description | Petrol | Diesel |
|-------------------|--------|--------|
| Rear bumper | | |
| Rear lamp panel | | |
| Rear panel | | |
| Rear crossmember | | |

| | | |
|------------------------------------|-------------|-------------|
| D Pillar closing panel L/H and R/H | | |
| Tailgate | | |
| Total Time | 27.1 | 27.1 |